

Geology and Groundwater Resources
of the Willow Bunch Lake Area (72H),
Saskatchewan

Map 1b Interrill Sands and Gravels

Surface Elev (masl) \ominus Depth to top
Depth to water \odot Thickness

(all units are in metres)
(depths are below ground surface)

LEGEND

F — F' Cross Section

- \circ E-log only
- \ominus E-log, geologist description
- \odot E-log, driller's log
- \bullet SRC Observation Well
- \star Flowing well/testhole

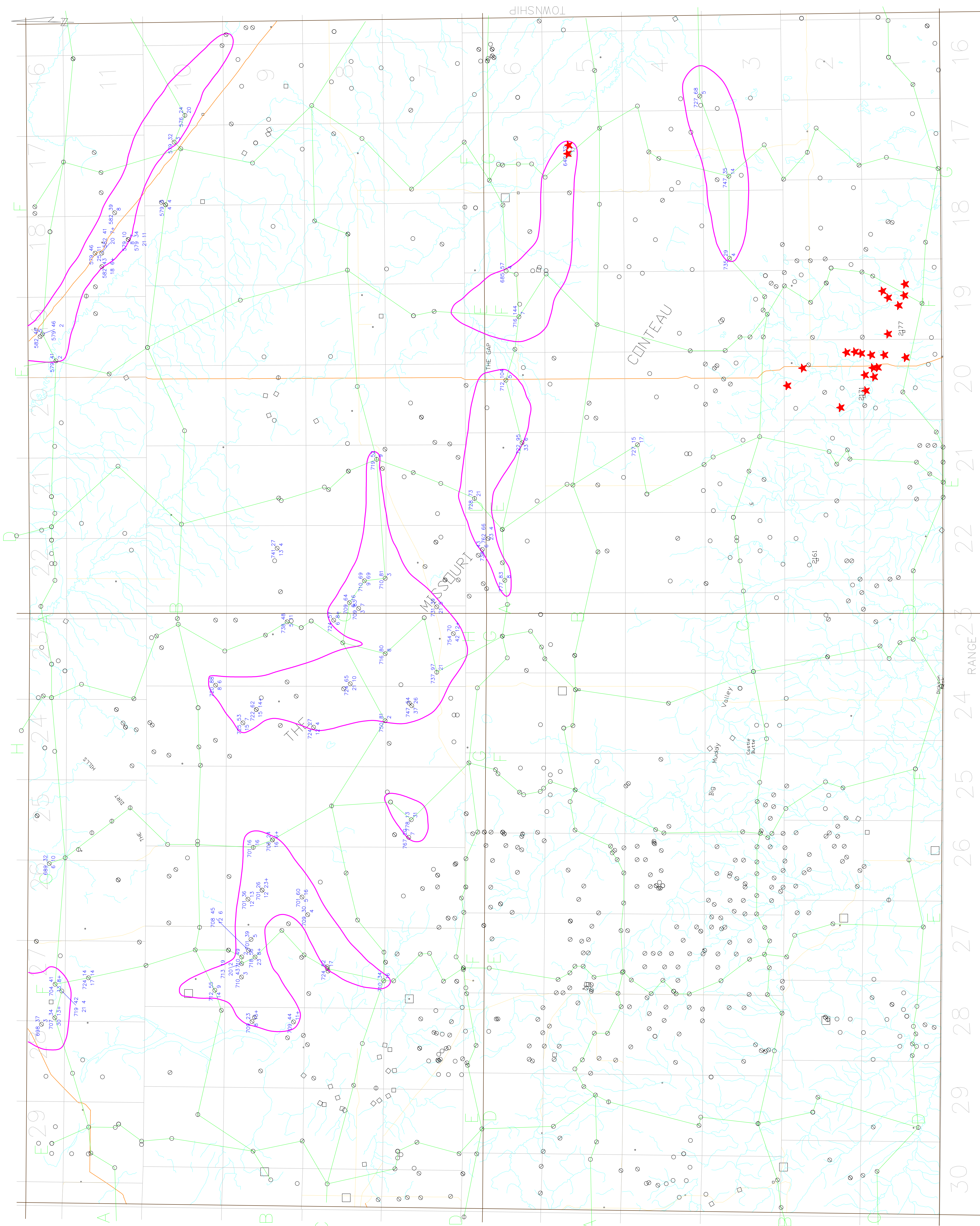

This document may not be copied without the consent of the authors. However, copies may be made, except for resale, for personal or internal use of the client, provided the original publication is cited where applicable.

These maps are accompanied by a series of cross sections which depict the subsurface units along the transects shown on the map. The maps and cross sections are representations of the data taken from the testholes and wells indicated on the maps. The boundaries outline areas in which the aquifer or geologic unit is likely to be found. Aquifers and other geologic units may not always occur continuously within the areas shown, may not be found at a specific site or may occur at elevations other than those indicated. Discontinuous water-bearing zones may be found outside the boundaries shown.

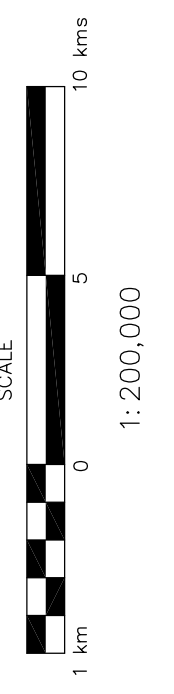

A portion of this work was done under contract to the Saskatchewan Water Corporation. This support is gratefully acknowledged.



Accompanies:
Millard, M.J., 1993: Geology and
Groundwater Resources of the Willow Bunch
Area (72H), Saskatchewan, Saskatchewan
Research Council Report R-1210-1-E-93.
and drawing 72H.gpr.04g