

E.K. SAUER

CROSS SECTION AT GRONLID FERRY

Report 0044    March 26, 1980

*E. A. Christiansen Consulting Ltd.*

CONSULTING GEOLOGIST

BOX 3087  
SASKATOON, SASKATCHEWAN, CANADA  
S7K 3S9

PHONE 374-6700

March 26, 1980

Dr. E.K. Sauer  
Department of Civil Engineering  
University of Saskatchewan  
Saskatoon, Saskatchewan

Dear Dr. Sauer:

Enclosed is a colored copy of Drawing 0044-001-01.- "Cross section at Gronlid Ferry". The matte positive is under a separate cover.

If you have any queries, please let me know.

Sincerely yours,

E.A. Christiansen

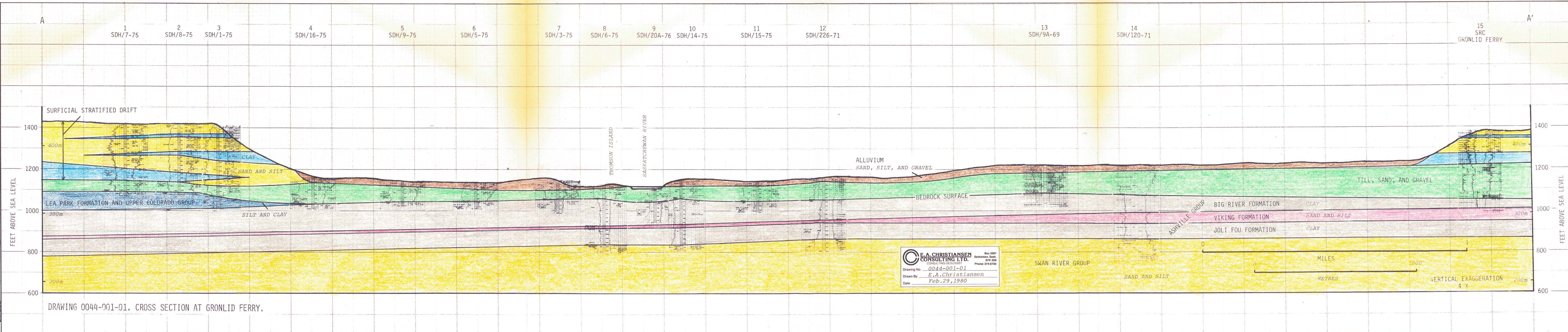
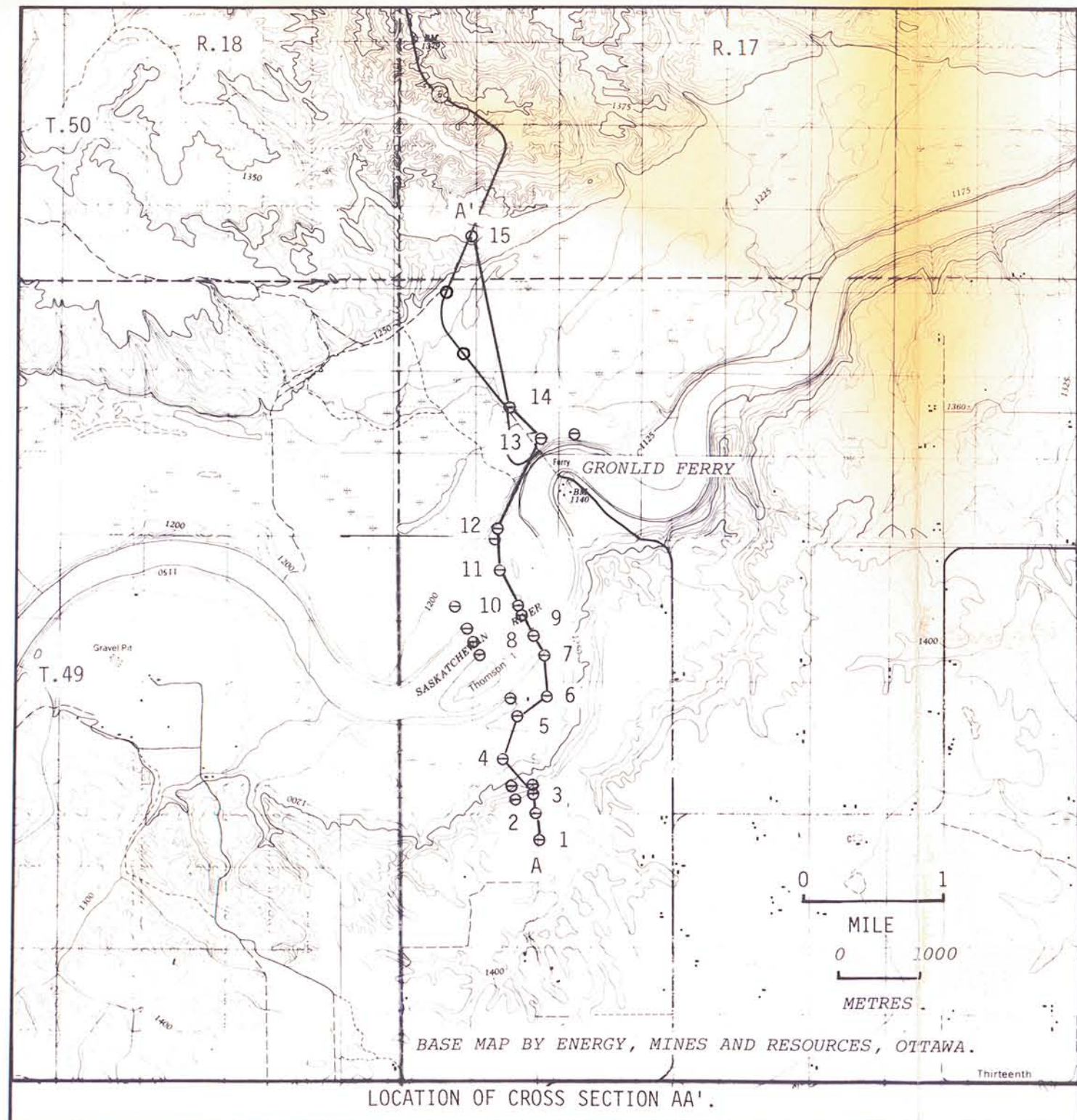

DRAWING 0044-001-01. CROSS SECTION AT GRONLID FERRY.